



Green Lanes, London, N13
Chain Free £250,000 Leasehold

Anthony Webb
ESTATE AGENTS

Green Lanes, London, N13

A newly converted one bedroom ground floor maisonette located to the rear of this Edwardian building in the heart of Palmers Green. The property has been created with wheelchair access in mind including a ramp to the entrance, a wet room and widened doors frames through out.

Vibrant Green Lanes offers a wide variety of shops, cafes and restaurants with fantastic road/bus transport links including Palmers Green mainline station into Moorgate. Southgate underground station is a short ride away via the W6 bus route. Both Broomfield and Groveland Parks are also within easy reach.

Gated access via the the side of the main building • Private gate and ramp to own front door • Open plan living/kitchen space • Modern fitted kitchen • Modern wet room • Double bedroom • Gas central heating • Double glazing • Rear outside space to be allocated.

New lease to be created of 125 years
Ground rent T.B.C
Service charges T.B.C
Enfield Council Tax Band B

- One bedroom
- Ground floor maisonette
- Own entrance
- Modern living/kitchen space
- Modern wet room
- Double glazing/gas central heating
- Designed for wheelchair users
- Rear outside space





Anthony Webb



Anthony Webb



Anthony Webb



Anthony Webb

Green Lanes London N13 4BS

Tenure: Leasehold
Gross Internal Area: 370.00 sq ft



Energy Efficiency Rating		Current	Potential
Very energy efficient - lower running costs			
(92 plus) A			
(81-91) B			
(69-80) C			
(55-68) D			
(39-54) E			
(21-38) F			
(1-20) G			
Not energy efficient - higher running costs			
England & Wales		EU Directive 2002/91/EC	
Environmental Impact (CO ₂) Rating		Current	Potential
Very environmentally friendly - lower CO ₂ emissions			
(92 plus) A			
(81-91) B			
(69-80) C			
(55-68) D			
(39-54) E			
(21-38) F			
(1-20) G			
Not environmentally friendly - higher CO ₂ emissions			
England & Wales		EU Directive 2002/91/EC	

Ground floor
34.4 sq.m. (370 sq.ft.) approx.

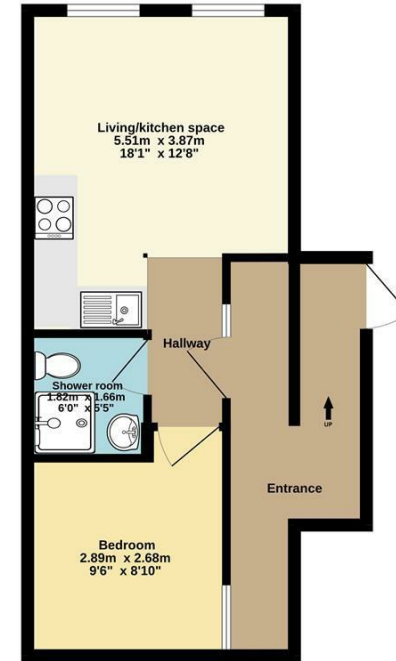

TOTAL FLOOR AREA: 34.4 sq.m. (370 sq.ft.) approx.
While every attempt has been made to ensure the accuracy of the floorplan contained here, measurements of doors, windows, rooms and any other items are approximate and no responsibility is taken for any error, omission or mis-statement. This plan is for illustrative purposes only and should be used as such by any prospective purchaser. The services, systems and appliances shown have not been tested and no guarantee as to their operability or efficiency can be given.
Made with Metropix ©2025

Property particulars as supplied by Anthony Webb Estate Agents are set out as a general outline in accordance with the Property Misdescriptions Act (1991) only for the guidance of intending purchasers of lessees, and do not constitute any part of an offer or contract. Details are given without any responsibility, and any intending purchasers, lessees or third parties should not rely on them as inspection or otherwise as to the correctness of each of them. We have not carried out a structural survey and the services, appliances and specific fittings have not been tested. All photographs, measurements, floor plans and distances referred to are given as a guide only and should not be relied upon for the purchase of carpets or any other fixtures statements or representations of fact, but must satisfy themselves by or of fittings, gardens, roof terraces, balconies and communal gardens as well as tenure and lease details cannot have their accuracy guaranteed for intending purchasers. Lease details, service ground rent (where applicable) are given as a guide only and should be checked and confirmed by your solicitor prior to exchange of contracts. no person in the employment of Anthony Webb has any authority to make any representation or warranty whatever in relation to this property.

348 Green Lanes, Palmers Green, London N13 5TJ
020 8882 7888
palmersgreen@anthonywebb.co.uk
anthonywebb.co.uk

Anthony Webb
ESTATE AGENTS